

NOTES:

1. VALVES ARE MANUFACTURED IN ACCORDANCE WITH AWWA C517-05, RESILIENT-SEATED CAST IRON ECCENTRIC PLUG VALVES
2. VALVES ARE RATED AT 150 PSI CWP AND APPLICABLE FOR SERVICE TEMPERATURES FROM 33° THROUGH 150°F.
3. END FLANGE DIMENSIONS AND DRILLING ARE IN ACCORDANCE WITH ANSI/AWWA C111/A21.11 "RUBBER GASKETED JOINTS FOR DUCTILE-IRON PRESSURE PIPE AND FITTINGS".
4. VALVES ARE TESTED IN ACCORDANCE WITH AWWA C517-05 AS FOLLOWS:
LEAKAGE TEST:
DIRECT PRESSURE: 150 PSI FOR 30 SEC
HYDROSTATIC TEST: 225 PSI FOR 60 SEC
5. PAINT: BLUE - SEMI-GLOSS METAL PRIMER
6. ELASTOMERS AVAILABLE IN NITRILE, EPDM, NEOPRENE.

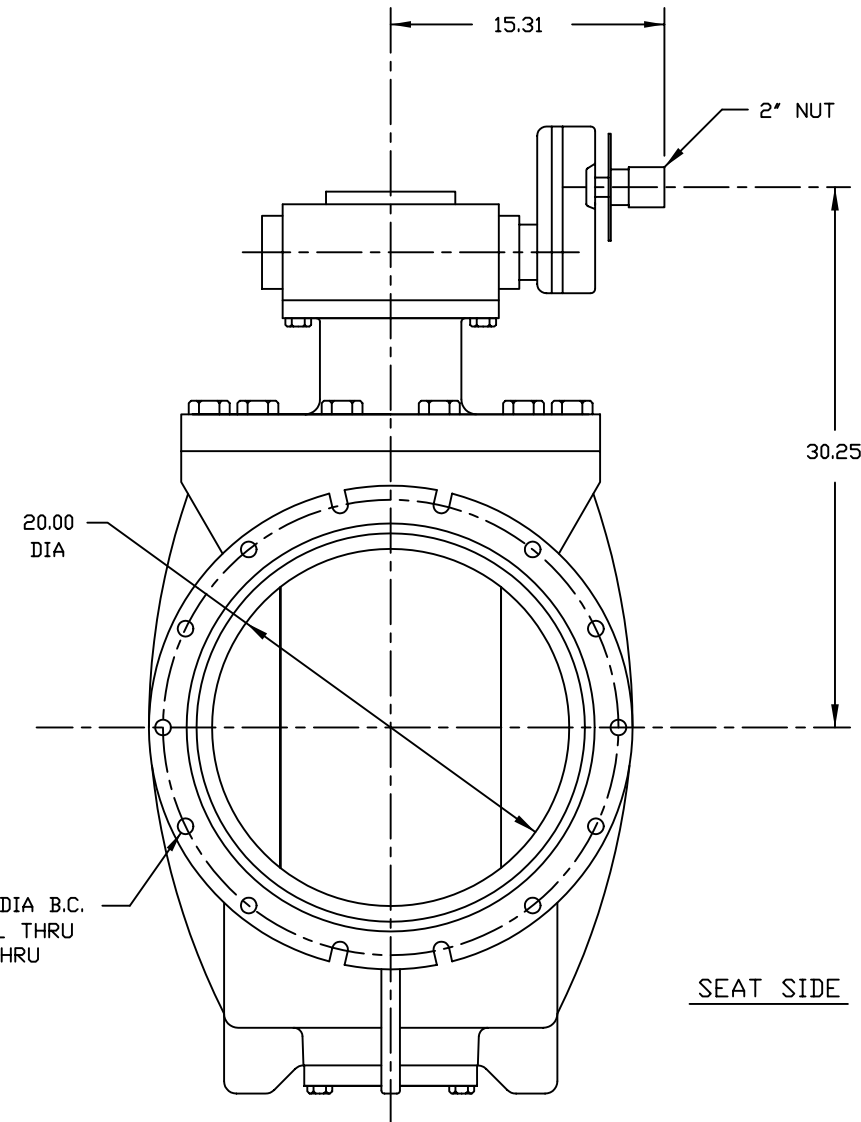
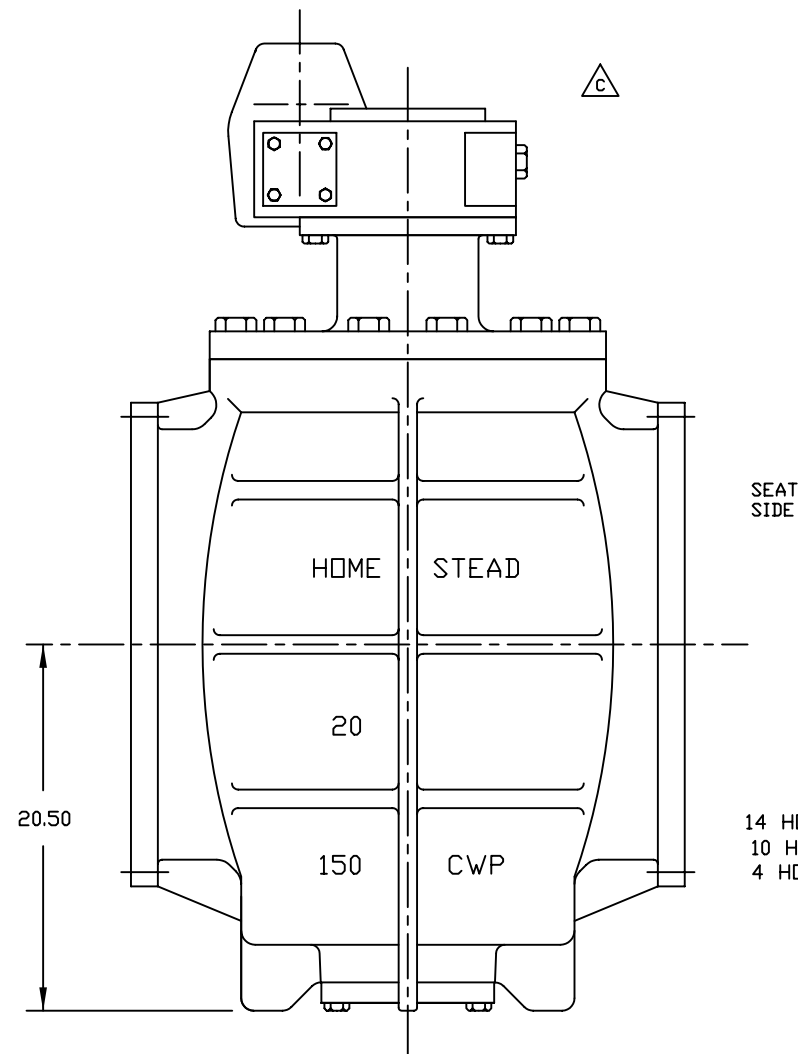

14 HOLES EQ SP ON 25.50" DIA B.C.
10 HOLES - .875" DIA DRILL THRU
4 HOLES - .875 SLOTTED THRU
LOCATED AS SHOWN
(TYP EACH FLANGE)

18	ACTUATOR	COMMERCIAL W/ 2" NUT
17	KEY	STEEL
16	CAPSCREW	STEEL, ZINC PLATED
15	COVER PLATE	A126 CLB
14	CAPSCREW	STEEL, ZINC PLATED
13	SEAL	SEE NOTE 6
12	PIPE PLUG	IRON
11	CAPSCREW	STEEL, ZINC PLATED
10	SEAL	SEE NOTE 6
9	HEX NUT	STEEL, ZINC PLATED
8	STUD	STEEL, ZINC PLATED
7	PACKING GLAND	A126 CLB
6	PACKING	V-RING, SEE NOTE 6
5	THRUST BEARING	PTFE
4	BEARING	SELF-LUBRICATED
3	PLUG	A536 65-45-12/NOTE 6
2	CAP	A126 CLB
1	BODY	A126 CLB/NICKEL OVERLAY
NO.	PART NAME	MATERIAL

PARTS LIST

HOMESTEAD® VALVES
A DIVISION OF OLSON TECHNOLOGIES, INC.
160 WALNUT ST. ALLENTOWN, PA. 18102 (610) 770-1100
WWW.HOMESTEADVALVE.COM

REV	ISSUE	BY	APPR	DATE	TITLE	NUMBER
C	S1226	RH		5/5/10	20" E127 - GEAR OPERATED ECCENTRIC PLUG VALVE	SK-4092
B	S1186	RH	DED	10/21/09		
A	S972	RH	DED	2/27/08		