

**NOTES:**

1. VALVES ARE MANUFACTURED IN ACCORDANCE WITH ANSI/AWWA C517, "RESILIENT-SEATED CAST IRON ECCENTRIC PLUG VALVES". LATEST REVISION.
2. MECHANICAL JOINT END FLANGE DIMENSIONS ARE IN ACCORDANCE WITH AWWA C111/A21.11 "RUBBER-GASKET JOINTS FOR DUCTILE-IRON PRESSURE PIPE AND FITTINGS".
3. PAINT: BLACK - SEMI-GLOSS METAL PRIMER
4. ELASTOMERS AVAILABLE: BUNA-N  
EPDM  
NEOPRENE  
VITON

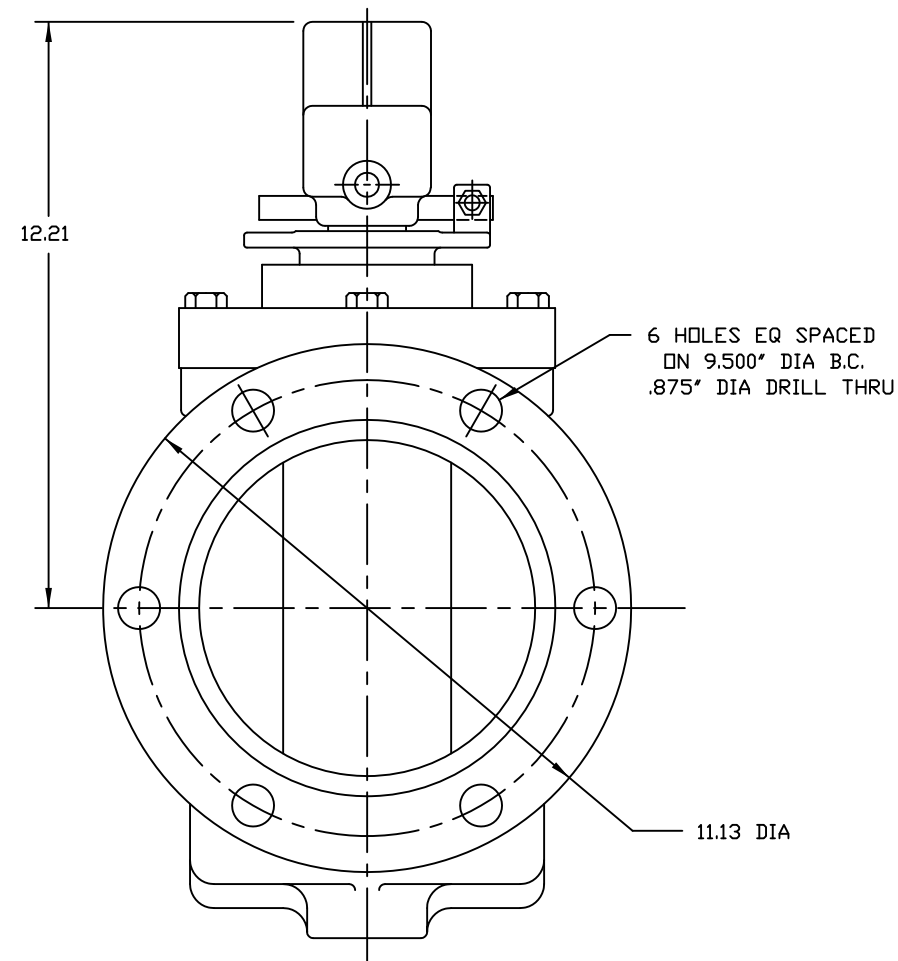
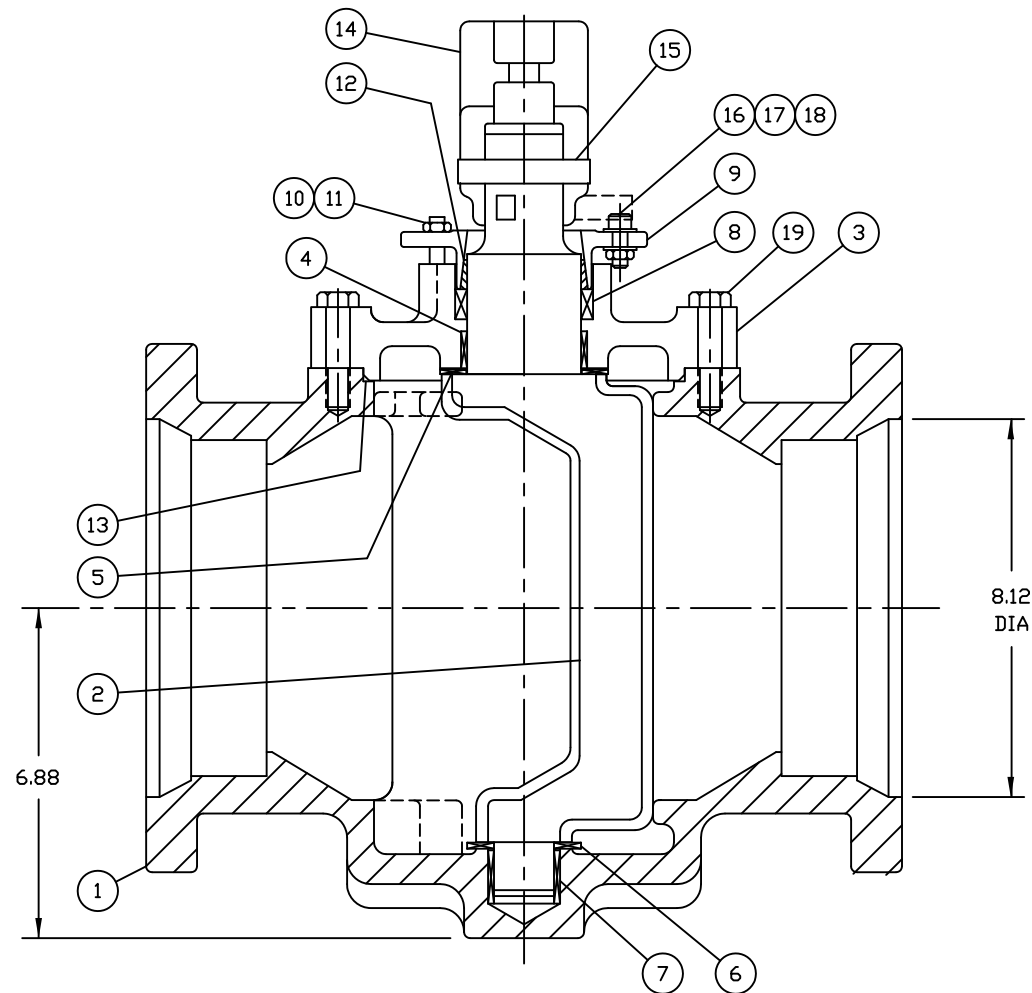

21	PIPE PLUG	A126 CLB
20	STOP BOLT	STEEL, ZINC PLATED
19	CAP SCREW	STEEL, ZINC PLATED
18	FLAT WASHER	STEEL, ZINC PLATED
17	JAM NUT	STEEL, ZINC PLATED
16	MEMORY BOLT	STEEL, ALLOY A574
15	PIN	STAINLESS STEEL
14	STOP COLLAR	A126 CLB
13	SEAL	SEE NOTE 4
12	BRAKE RING	POLYMER
11	JAM NUT	STEEL, ZINC PLATED
10	STUD	STEEL, ZINC PLATED
9	MEMORY PLATE	A126 CLB
8	PACKING	V-RING/SEE NOTE 4
7	RADIAL BEARING	PERM. LUBRICATED 316 SS
6	THRUST BEARING	PTFE
5	THRUST BEARING	PTFE
4	RADIAL BEARING	PERM. LUBRICATED 316 SS
3	COVER PLATE	A126 CLB
2	PLUG	A126 CLB/ SEE NOTE 4
1	BODY	A126 CLB/NICKEL SEAT
NO.	PART NAME	MATERIAL

**PARTS LIST**

**HOMESTEAD VALVES**  
A DIVISION OF OLSON TECHNOLOGIES, INC.  
160 WALNUT ST. ALLENTOWN, PA. 18102 (610) 770-1100

TITLE			
6" E127 ECC MECHANICAL JOINT w/ 2" SQUARE NUT			
REV	ISSUE	BY	DATE
B	S1745	RH	8/18/17
A	S1060	RH	12/18/08
NUMBER			SK-4019